

## B16.47 Series B Class 150 Weld Neck & Blind

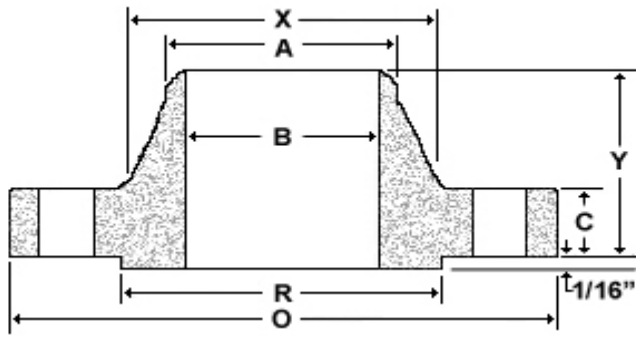

**Weld Neck**

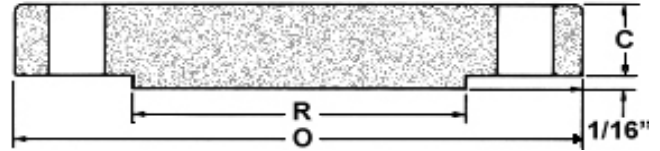

**Blind**

Nom Size	Thickness						Drilling				Weight			
	OD	Weld Neck	Blind	OD of RF	Dia at Base	Bore	LTH	Dia Bevel	Bolt Circle	Bolt Length	Hole Dia	# of Holes	Weld Neck	Blind
	O	C	C	R	X		B	Y	A		(1)	(2)		
26	30.94	1.57	1.69	28.00	26.94	To be specified by Purchaser.	3.44	26.06	29.31	5.50	0.88	36	120	373
28	32.94	1.69	1.82	30.00	28.94		3.69	28.06	31.31	5.75	0.88	40	140	454
30	34.94	1.69	1.94	32.00	31.00		3.88	30.06	33.31	6.00	0.88	44	150	543
32	37.06	1.75	2.07	34.00	33.06		4.19	32.06	35.44	6.25	0.88	48	170	648
34	39.56	1.88	2.19	36.25	35.12		4.28	34.06	37.69	6.75	1.00	40	210	783
36	41.62	2.00	2.25	38.25	37.19		4.57	36.06	39.75	6.75	1.00	44	240	890
38	44.25	2.07	2.44	40.25	39.25		4.82	38.12	42.12	7.50	1.12	40	290	1089
40	46.25	2.13	2.57	42.50	41.31		5.00	40.12	44.12	7.75	1.12	44	310	1247
42	48.25	2.25	2.63	44.50	43.38		5.19	42.12	46.12	7.75	1.12	48	345	1393
44	50.25	2.32	2.75	46.50	45.38		5.32	44.12	48.12	8.00	1.12	52	370	1579
46	52.81	2.38	2.88	48.62	47.44		5.63	46.12	50.56	8.50	1.25	40	435	1824
48	54.81	2.50	3.00	50.75	49.50		5.82	48.12	52.56	8.75	1.25	44	480	2045
50	56.81	2.63	3.13	52.75	51.50		6.00	50.12	54.56	9.00	1.25	48	520	2284
52	58.81	2.69	3.25	54.75	53.56		6.13	52.12	56.56	9.25	1.25	52	550	2547
54	61.00	2.75	3.38	56.75	55.62		6.32	54.12	58.75	9.50	1.25	56	620	2848
56	63.00	2.82	3.50	58.75	57.69		6.50	56.12	60.75	9.75	1.25	60	650	3144
58	65.94	2.88	3.62	60.75	59.69		6.82	58.12	63.44	10.00	1.38	48	780	3560
60	67.94	2.94	3.75	63.00	61.81		7.00	60.12	65.44	10.25	1.38	52	850	3913

Dimensions are in inches. Weights are in pounds.

(1) Bolt lengths are calculated based on bolting one WN to one blind.

(2) Bolt diameter should be 1/8" less than the bolt hole diameter.

**Note:**

Larger sizes as well as intermediate sizes can be furnished.